

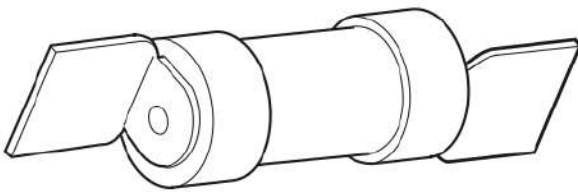

SHRI TULSI SWITCHGEAR PVT. LTD.

Mfg. : of Control, Connecting, Insulating, Measuring, Signaling & Solid State Devices

NS TYPE HRC FUSE LINK TECHNICAL SPECIFICATION & DIMENSIONAL DETAILS



FRONT VIEW OF STAGGERED TAG
NS FUSE LINK

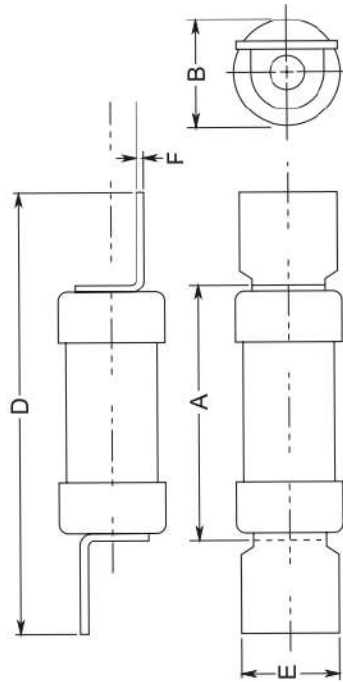

Time-Current Characteristic Curve (Full Size Curves Available)

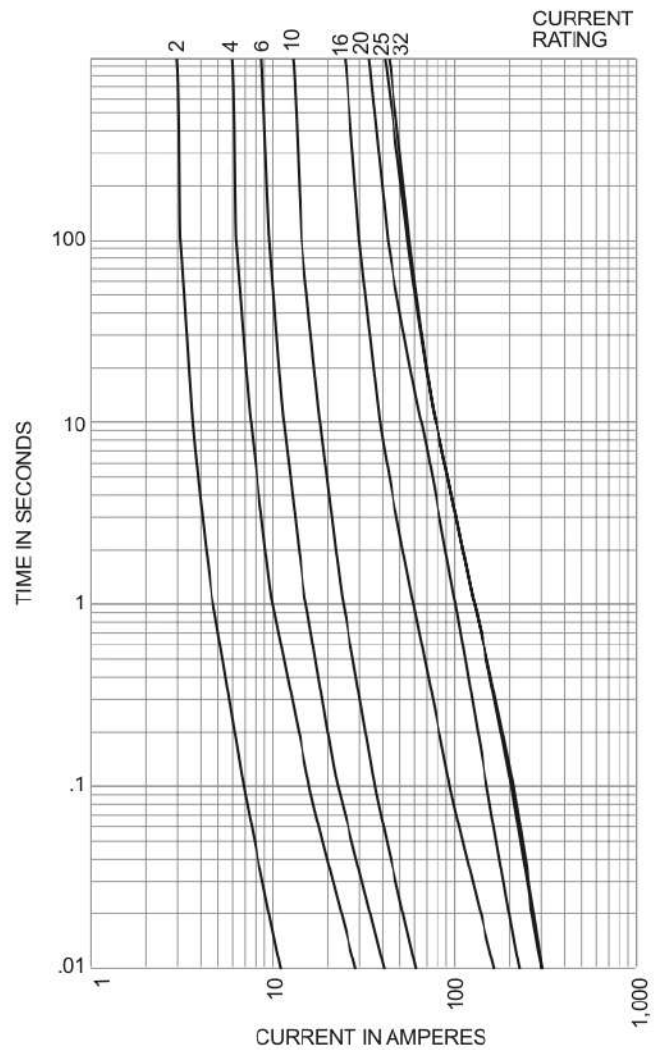

Electrical Characteristics

Catalog Number	Ampere Rating	I ² T (Amp ² Seconds)			Nom Watts Loss	Rated Voltage	Dimensions (mm)				
		Pre-Arcing	Total At 415V	Total At 550V			A	B	D	E	F
STNS-2	2	1.3	4.6	5	0.9	550AC	34.10	13.90	57.90	10.90	.78
STNS-4	4	8	27	30	1.4						
STNS-6	6	29	100	115	1.8						
STNS-10	10	120	400	490	2.1						
STNS-16	16	120	470	730	1.8						
STNS-20	20	260	1070	1700	1.8						
STNS-25	25	560	2300	3550	2						
STNS-32	32	710	3000	5000	2.9						



(SINCE 1989)

SNF

LKBL TYPE H.R.C. FUSE FITTING UPTO 32A 550V AC/DC



SNF 20/32



DIN RAIL MOUNTING



EASY INSTALLATION

DESIGN DESCRIPTION:-

STS Lockable H.R.C. Fuse fitting series SNF-20/32 Amps is designed to accommodate with both bolted panel and a direct 35mm DIN rail mounting features. The product is suitable to the compact range of offset blade tag fuse links. The combination offers significant saving in time and power loss as well as reduction in cost. Fuse holders are perfectly designed to the requirements of national and international standards ISS-9224-1979; ISS-13703-1993.

FEATURES:-

CARRIER WITH CAM LOCKING

ARRANGEMENT:- Fabulous and unique locking carrier having cam locking arrangement without carrier contact provides the low wattage loss due to low contact resistance between the fuse link and base contact. An improved contact pressure develops between link blade and base contact through cam locking arrangement.

EASY REMOVAL OF THE CARRIER:-

Easy removal of fuse carrier from the fuse base is possible with the help of cam lock arrangement.

HIGH QUALITY BASE MATERIAL:-

Material used in the fuse base housing is GLASS FILLED NYLON which contains the best mechanical, thermal and electrical characteristics by which the fuse base holds non flammable, non hygroscopic, and unbreakable.

EASY & SAFE INSTALLATION

Installation on the DIN Rail is simply a snap action. So the fitting and removal of the fuse holder on the panel is very easy and time saving.

DUAL MOUNTING CAPABILITY:-

The standard design of SNF-20/32 is suitable to be mounted on bolted panel and as a direct 35mm DIN rail mounting arrangement.

AN ISO 9001:2008 CERTIFIED COMPANY



SHRI TULSI SWITCHGEAR PVT. LTD.-NOIDA (INDIA)

APPLICATION :- STS SNF 20/32 Fuse Fitting along with fuse links provides safe and easy method of protecting a wide range of electrical equipment such as Lighting, Heating, control and motor equipment etc. H. R. C. Fuse can be installed on DIN rails by a simple & easy snap action similarly for removal a simple operation by a screw driver is enough.

Selection Table

FUSE HOLDER TYPE	CURRENT RATING AMP	MAX. VOLTS AC/DC	FUSE LINKS TYPE
SNF 20/32	20	550	NS TYPE 2 Amps NS TYPE 4 Amps NS TYPE 6 Amps NS TYPE 10 Amps NS TYPE 16 Amps NS TYPE 20 Amps
SNF 20/32	32	550	NS TYPE 25 Amps NS TYPE 32 Amps

Technical Details :

Rated voltage	500 V Ac/Dc
Rated Current	20/32 Amp.
Temperature Range	-20°C to +65°C
Type of Connection	Front Connection
Mounting	Bolted Panel & 35 mm Din Rail
ISS Reference	13703 Pt-1 Sec-2, 1993
Housing Material	Non Flammable, Hygroscopic & unbreakable
Insulation resistance	More Than 100 Mohms
Dielectric Strength	2.5 K.V., 50 Hz for 1 minute between live parts and housing

Rating Amps.	TYPE	Max. Cable(A1)mm ²	Fuse Link type	Dimensions
20	SNF20/32	4	As per IS 13703 (NS Type)	As per drawing
32	SNF20/32	10	As per IS 13703 (NS Type)	As per drawing

Dimensional Detail : DIMENSIONS (mm)

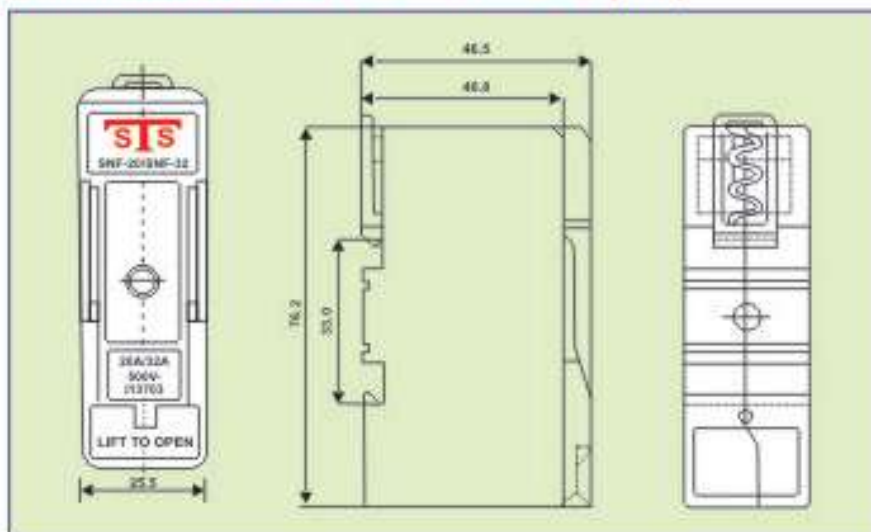

Authorised Dealer :